

#4502

★  
**OPEN RANGE**  
 Journeyer

2010 Travel Trailer  
 JT337RLS  
 Effective Date: 03/10/09

# MSRP PRICE SHEET

**DEALER NAME:** Robert Crist RV  
**VIN #:** 5XMTJ3623A5001348

**DÉCOR OPTIONS:**

- Haversham (Blue/Brown)
- Lifelong (Green)
- Sheridan (Neutral/Tan)

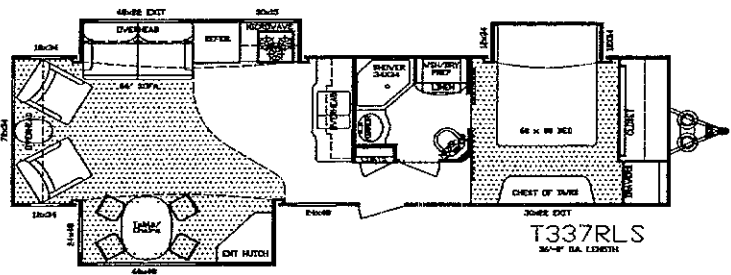

JT337RLS

**OPTIONAL FEATURES**

	Price	Description
X	\$651	2nd A/C 13,500 BTU, Non-Ducted
	\$1,113	Dual Pane Windows
X	\$735	16" Aluminum Wheels & Tires
X	\$210	Power Tongue Jack
	\$350	Fantastic Fan in: Bedroom / Bathroom / Kitchen
X	\$693	Fireplace
X	\$693	19" Flat Screen Bedroom TV
X	\$532	Two Recliners IPO Swivel Rockers
	\$1,253	Slide-Out Awning Covers (3)

	Price	Description
X	\$700	Four Seasons Protection Package (Mandatory)
X	\$2,100	Entertainment Package (Mandatory)
X	\$3,500	Executive Living Package (Mandatory)
X	\$91	RVIA
	\$273	Q.A.I. Construction (Canadian Dealers ONLY)
	\$91	Go RVing MEP Fee (Canada)
		State Seal
X	\$476	Island on Castors - Journeyer Models

**Four Seasons Protection Package:** Atwood High Performance Furnace, Double Insulated Baggage Doors, Heated Storage Area, Heated Underbelly, Insulated Slide-Floor, Heated & Enclosed Dump Valves, Vented Attic, Remote Digital Thermostat, R-9 Walls, R-21 Floor, up to R-28 Ceiling.

**Entertainment Package:** 32" Digital TV, DVD/CD/MP3/AM/FM Player w/ Surround Sound Speakers, TV Antenna and booster.

<b>BASE PRICE:</b>	<u>\$34,286.00</u>
<b>OPTIONS:</b>	<u>\$10,381.00</u>
<b>DISCOUNT:</b>	_____
<b>DESTINATION CHG:</b>	<u>\$2,065.00</u>
<b>FUEL SURCHARGE:</b>	<u>\$345.00</u>
<b>TOTAL:</b>	<u>\$47,077.00</u>

\* Fuel surcharge to fluctuate with current fuel prices and may reflect an increase or decrease accordingly.

**Executive Living Package:** INTERIOR OPTIONS - Large 8 Cubic Ft. Refer, 10 Gal Quick Recovery Water Heater, 15,000 BTU A/C, Power Vent, Residential Hide-a-bed Sofa, Residential Mattress, Spice Rack, Pull-Out Pantry. EXTERIOR OPTIONS - Power Awning, "MaxxAir" Vent Cover, 15" Steel 6-Lug Wheels.

**Standard Features:** INTERIOR -High Output Range w/Ignitor and Large 22" Oven. HUD Approved Luan Wall Board, Maple Hardwood Raised Panel Glazed Cabinet Doors, Full Extension Drawer Guides, Fluorescent Light in Galley, Pull-Out Waste Basket, Portable Laundry Basket, Washer/Dryer Prep, Glass Shower Door & Surround, Sky Light above Shower, Cable Hook-up, Satellite Prep, Large Lavatory Bowl Sink, Porcelain Toilet, Motion Detector Night Light EXTERIOR - Exterior Utility Center w/Black Tank Flush, "Dexter" Wide Stance E-Z Lube Axles, Equa Flex Suspension, Radial Tires, Front & Rear Stabilizer Jacks, Large Triple 9" Entry Steps, Dual Outdoor Security Lights, Extended Gutter Spouts, Large Stainless Steel Assist Grab Handle.  
**NEW STANDARD FEATURES:** Wire and Frame for 2nd A/C (includes 50 amp service), Rear Ladder, Front Fiberglass Cap.

\*\*\* Prices, features and options are subject to change without notice.